

## TRACTION R1 - R2

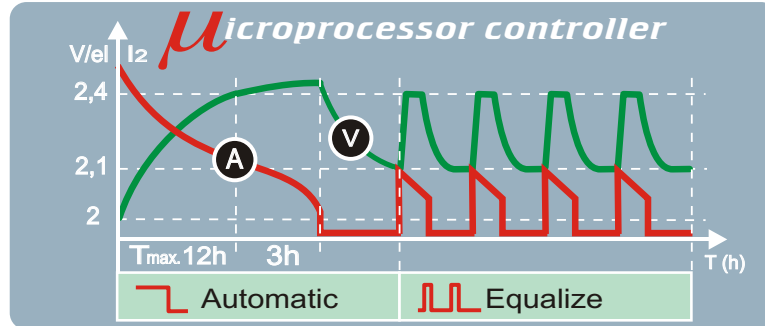

Carica batterie mono e trifase per la carica di accumulatori al piombo nella trazione elettrica. Sono caratterizzati dal design innovativo, dalle soluzioni tecniche costruttive che li rendono molto compatti e dall'estrema semplicità d'uso.

Single and three-phase battery chargers for charging of lead accumulators in electric traction. They are characterized by an innovative design, technical-constructive solutions that make them very compact, and extremely easy to use.



- Curva di carica Wa conforme alla norma DIN41774;
- controllo elettronico a microprocessore;
- parametri di carica e controllo ciclo visualizzabile tramite Led;
- fase di "equalizzazione" inseribile;
- protezione con fusibili e disgiuntori termici;
- carica ritardata di 3sec dal momento di accensione "ON".
- Wa charging curve according to DIN 41774;
- electronic control with microprocessor;
- charging parameters and cycle control visualizing with leds;
- insertable equalization phase;
- protection with fuses and thermic circuit breakers;
- 3 sec delayed charge from the moment of "ON" ignition.

Per gli articoli fare riferimento alla tabella a destra.  
For the item refer to the schedule on the right.

Es.: batt. 24Volt 120Ah 20A di carica:  
Ex.: batt. 24Volt 120Ah 20A charge:

R1 · 24 - 20

MODEL	Mains Voltage 50Hz Volt	Output Voltage Volt	Charge Current Amp	Nominal Capacity to refer to Ah	Size mm	Item N. VOLT - AMP
TRACTION R1	230 1ph.	12 - 24	10 - 15 - 20 - 30	60 - 90 - 120 - 180	250 x 210 x 280	R1 · [ ] - [ ]
TRACTION R2	230 1ph.	12 - 24 - 36	20 - 30 - 40 - 50	120 - 180 - 240 - 300	250 x 230 x 330	R2 · [ ] - [ ]
TRACTION R3	230 1ph.	12 - 24 - 36	40 - 50 - 60	240 - 300 - 360	250 x 260 x 400	R3 · [ ] - [ ]
TRACTION R4	230/400 3ph.	24 - 36 - 40 - 48	60 - 80 - 100 - 120	360 - 480 - 600 - 720	250 x 670 x 430	R4 · [ ] - [ ]

# R3 - R4

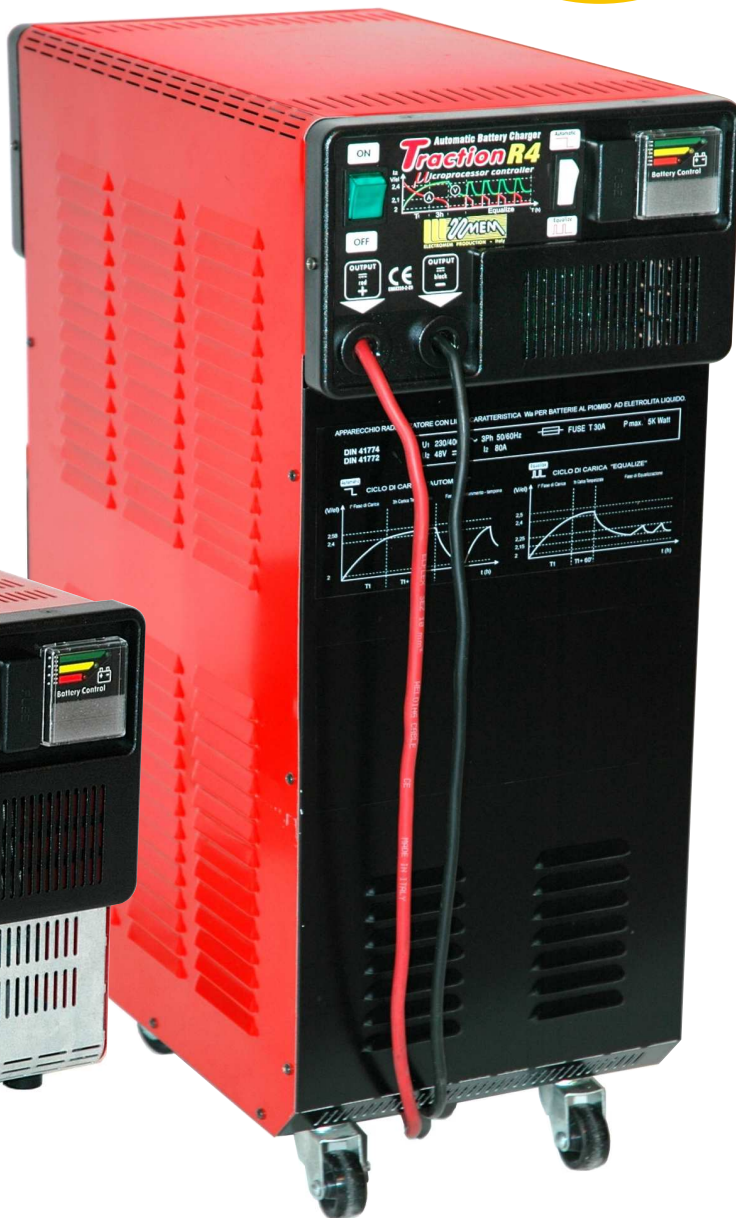
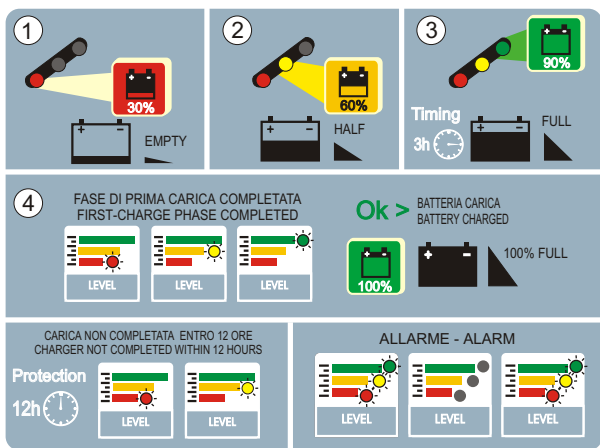

Amp	10A	15A	20A	30A	40A	50A	60A	80A	100A	120A
VOLT	60Ah	90Ah	120Ah	180Ah	240Ah	300Ah	360Ah	480Ah	600Ah	720Ah
12V	R1.12-10	R1.12-15	R1.12-20	R1.12-30	R2.12-40	R2.12-50	R3.12-60	-	-	-
24V	R1.24-10	R1.24-15	R1.24-20	R2.24-30	R2.24-40	R3.24-50	R3.24-60	R4.24-80	R4.24-100	R4.24-120
36V	-	-	R2.36-20	R2.36-30	R3.36-40	R3.36-50	R3.36-60	R4.36-80	R4.36-100	R4.36-120
40V	-	-	-	-	-	-	R4.40-60	R4.40-80	R4.40-100	R4.40-120
48V	-	-	-	-	-	-	R4.48-60	R4.48-80	R4.48-100	R4.48-120